

CAPACITY								
EVENT SPACE	TOTAL SQ FT	DIMENSION L X W	CEILING HEIGHT	THEATER STYLE	CLASS ROOM	HOLLOW SQUARE	BANQUET (8)	RECEPTION
Champ Room	1,404	-	-	-	-	-	-	-
Clover Room	638	-	-	-	-	-	-	-
Floor/Court	7846	-	-	-	-	-	-	-
Seating Area	48442	-	-	10,270	-	-	-	-
South Concourse	14,716	-	-	-	-	-	-	-

PRICING					
EVENT SPACE	USU AFFILIATED, CAMPUS GROUPS		EXTERNAL GROUPS, NON-UNIVERSITY		AMENITIES INCLUDED WITH THE ROOM RENTAL
	HALF DAY	FULL DAY	HALF DAY	FULL DAY	
Champ Room	-	-	-	-	Initial setup, basic audio package, projector package, complimentary WI-FI
Clover Room	-	-	-	-	Initial setup, basic audio package, projector package, complimentary WI-FI
Floor/Court and Seating Area	-	-	-	-	Initial setup, basic audio package, projector package, complimentary WI-FI
South Concourse	-	-	-	-	Initial setup, basic audio package, projector package, complimentary WI-FI

Procedures and rates are subject to change without notice.

Utah State University reserves the right to alter services and fees based on the size and scope of the event.

For scheduling and additional pricing information, please contact Sara Grove, CCA Production Services Scheduling Coordinator, at 435-797-3040 or sara.grove@usu.edu.

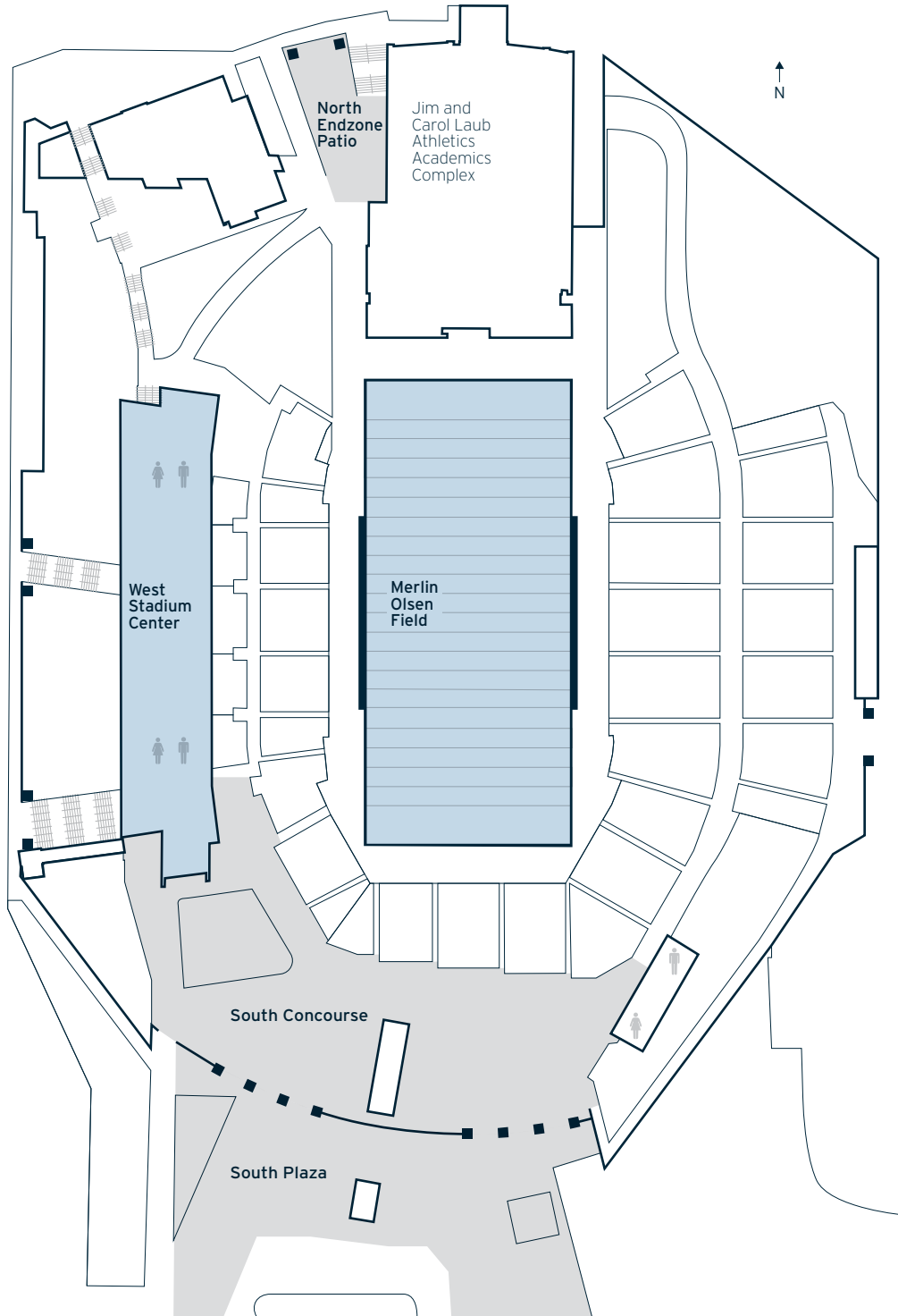

CAPACITY								
EVENT SPACE	TOTAL SQ FT	DIMENSION L X W	CEILING HEIGHT	THEATER STYLE	CLASS ROOM	HOLLOW SQUARE	BANQUET (8)	RECEPTION
Merlin Olsen Field	87,173	-	-	-	-	-	-	-
North Endzone Patio	5196	-	-	-	-	-	-	-
Seating Area	-	-	-	25513	-	-	-	-
South Concourse	45978	-	-	-	-	-	-	-
South Plaza	41774	-	-	-	-	-	-	-

PRICING					
EVENT SPACE	USU AFFILIATED, CAMPUS GROUPS		EXTERNAL GROUPS, NON-UNIVERSITY		AMENITIES INCLUDED WITH THE ROOM RENTAL
	HALF DAY	FULL DAY	HALF DAY	FULL DAY	
Merlin Olsen Field and Seating Area	-	-	-	-	Initial setup, basic audio package, projector package, complimentary WI-FI
North Endzone Patio	-	-	-	-	Initial setup, patio speakers, outdoor lighting
South Concourse	-	-	-	-	Initial setup, patio speakers, outdoor lighting
South Plaza	-	-	-	-	Initial setup, patio speakers, outdoor lighting

Procedures and rates are subject to change without notice.

Utah State University reserves the right to alter services and fees based on the size and scope of the event.

For scheduling and additional pricing information, please contact Sara Grove, CCA Production Services Scheduling Coordinator, at 435-797-3040 or sara.grove@usu.edu.

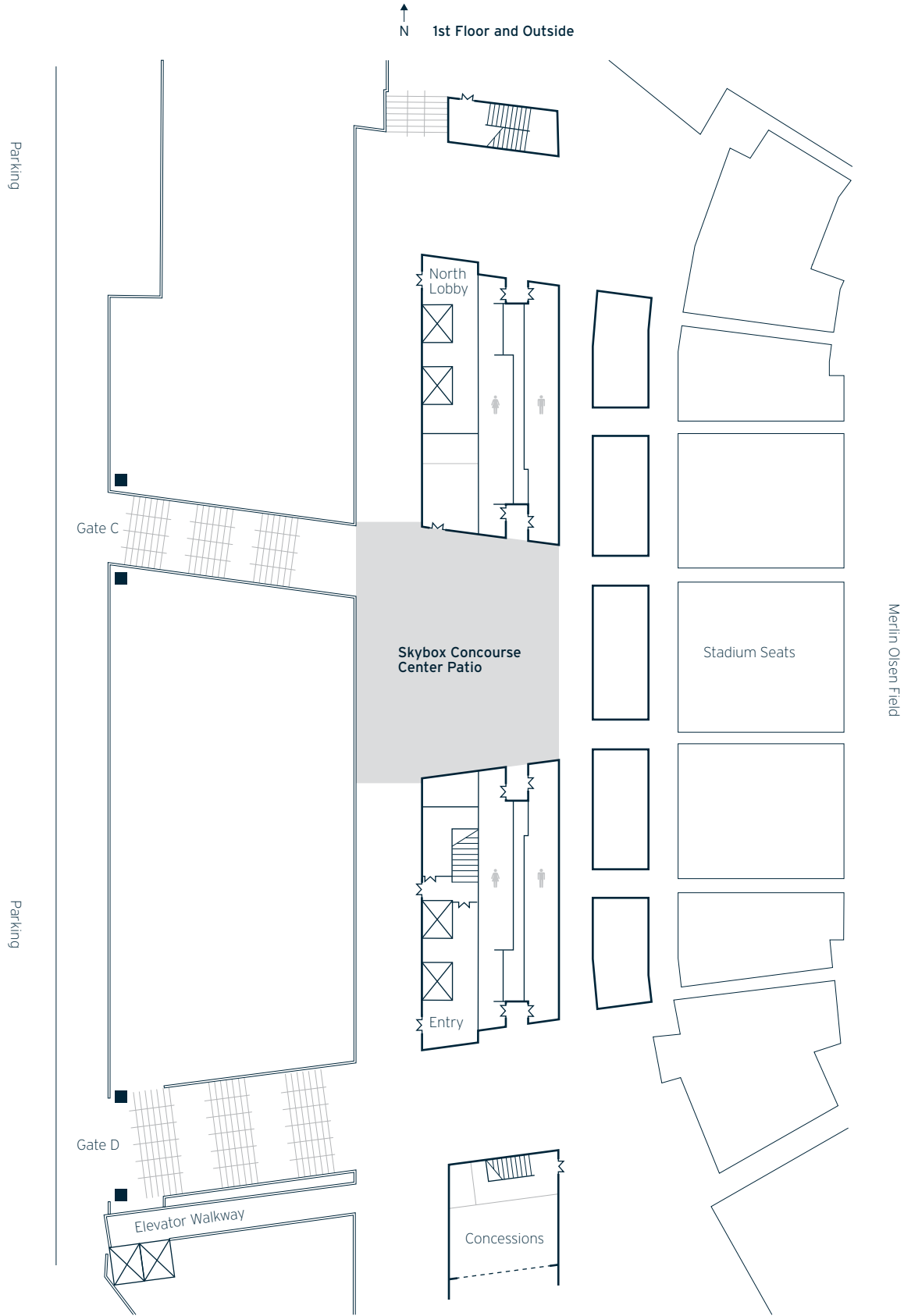

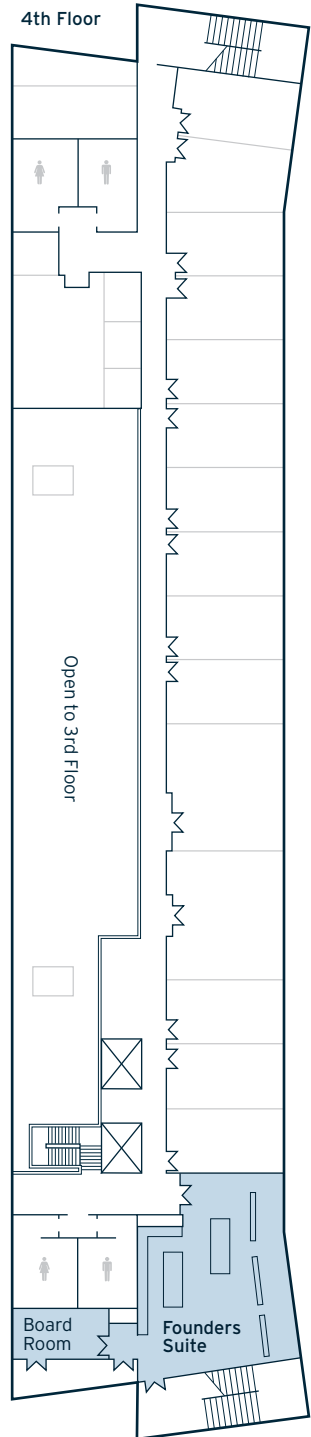
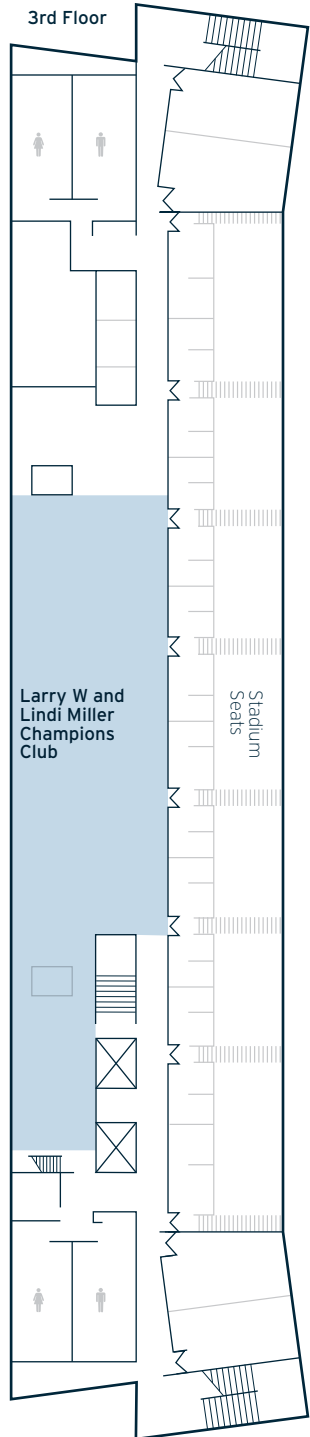

CAPACITY								
EVENT SPACE	TOTAL SQ FT	DIMENSION L X W	CEILING HEIGHT	THEATER	CLASS-ROOM	HOLLOW SQUARE	BANQUET (8)	RECEPTION
3rd Floor Lounge	540	30' x 18'	22'	45	-	-	20	-
Founders Suite	1,754	47' x 29'	8'	-	-	-	-	-
Founders Board Room	258	-	-	-	-	-	-	-
Larry W and Lindi Miller Champion's Club	5,090	114' x 28'	22'	400	-	-	185	727
Skybox Concourse Patio Center	18,457	-	-	-	-	-	-	-

PRICING					
EVENT SPACE	USU AFFILIATED, CAMPUS GROUPS		EXTERNAL GROUPS, NON-UNIVERSITY		AMENITIES INCLUDED WITH THE ROOM RENTAL
	HALF DAY	FULL DAY	HALF DAY	FULL DAY	
3rd Floor Lounge	-	-	-	-	-
Founders Suite	-	-	\$750	-	Boardroom, lounge and dining area, club seating, serving area, beverage coolers, basic audiovisual package, complimentary WI-FI
Larry W and Lindi Miller Champion's Club	\$630	\$910	\$900	\$1,300	TBD: Event insurance, evening parking (fewer than 200 guests and after 5 pm), initial setup, basic audio package, projector package, dimmable lighting, three floor signs, three gas fireplaces, grand staircase, and mezzanine
Skybox Concourse Patio Center	-	-	-	-	-

Procedures and rates are subject to change without notice.  
Utah State University reserves the right to alter services and fees based on the size and scope of the event.